

PSS 25 - MAINS POWER SUPPLY MODULE

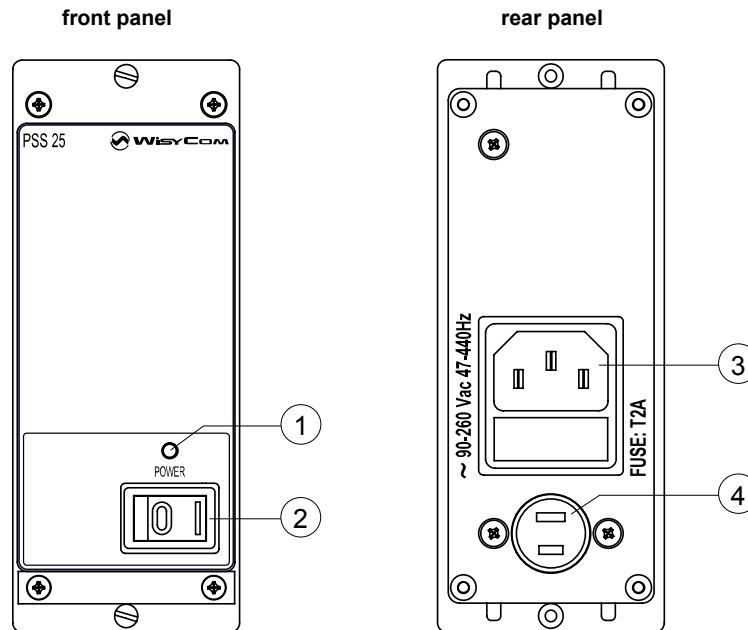

- 1) INDICATION: power on (red Led).
- 2) SWITCH: power on / off.
- 3) CONNECTOR: mains input, with mains fuse (connection to ground is needed).
- 4) CONNECTOR: 12 Vdc output, to the rack.

TECHNICAL SPECIFICATIONS

- Input mains power : 90 ÷ 264 Vac - 40 VA max.
- Input mains fuse : T2A.
- Output power : 12Vdc (± 5%) - 2.5 A max.
- Operating temperature : -10 ÷ +55 °C.
- Size : 123 x 49 x 160 mm (n. 1 module wide).
- Weight : 620 g approx.
- Complies with : EN 61000-3-2
EN 60950-1